

PRECAST CONCRETE KERBS

NTS

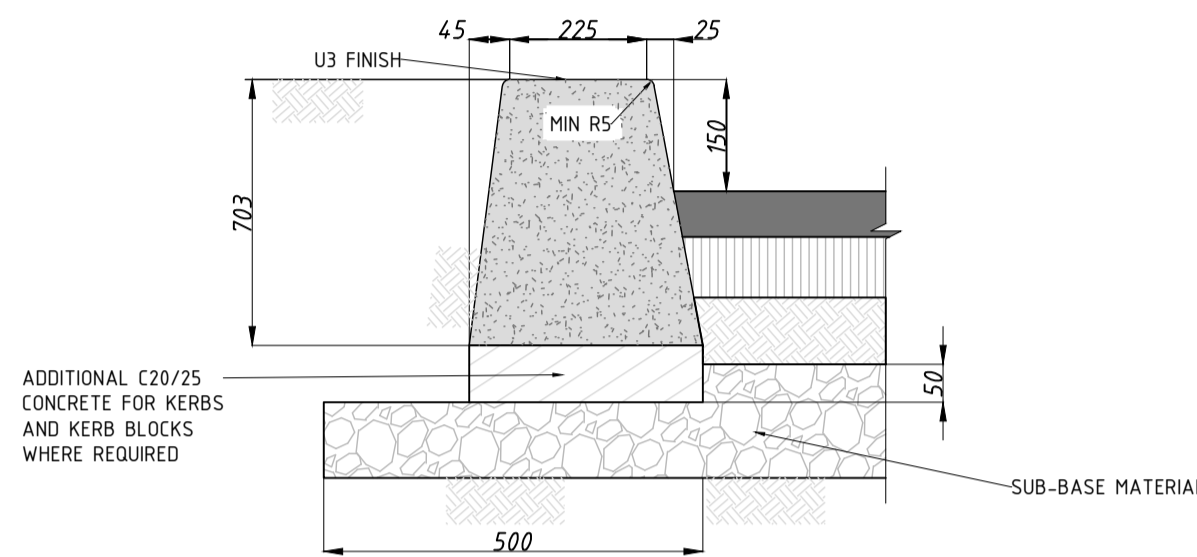

IN-SITU CONCRETE KERBS

NTS

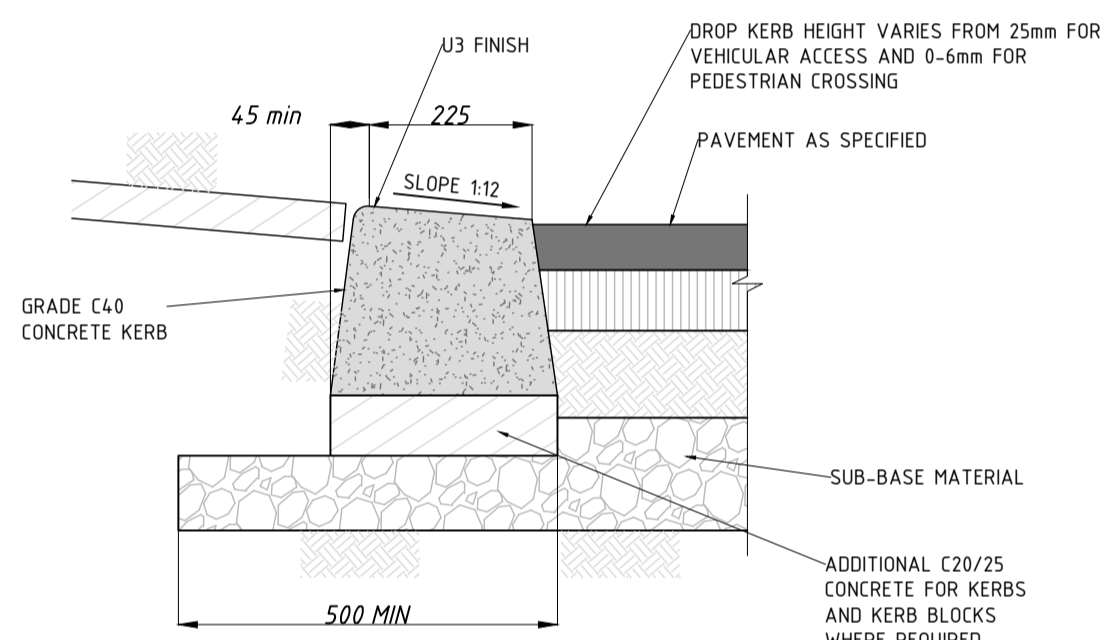

IN-SITU CONCRETE DROPPED KERB

NTS

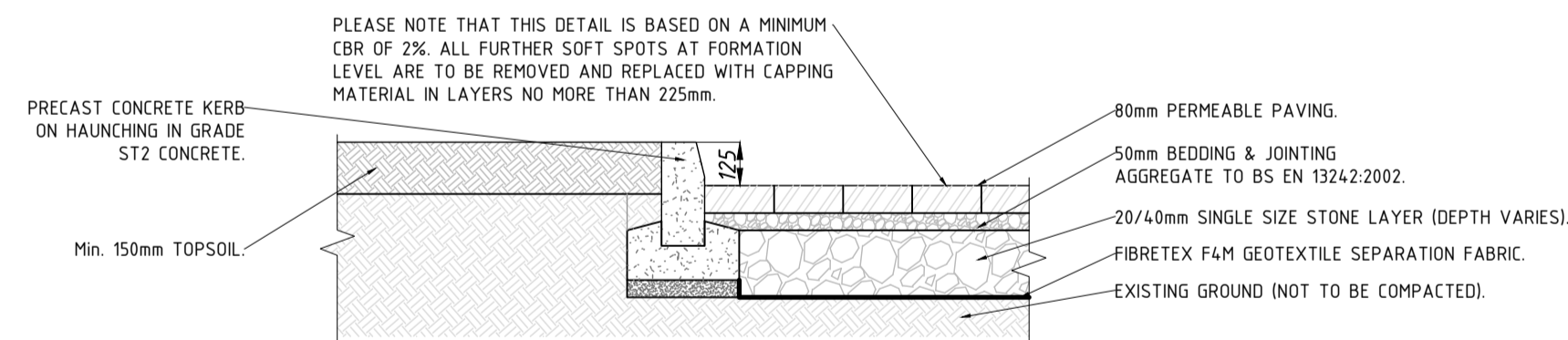

IN-SITU CONCRETE DROPPED KERB

SCALE 1:20

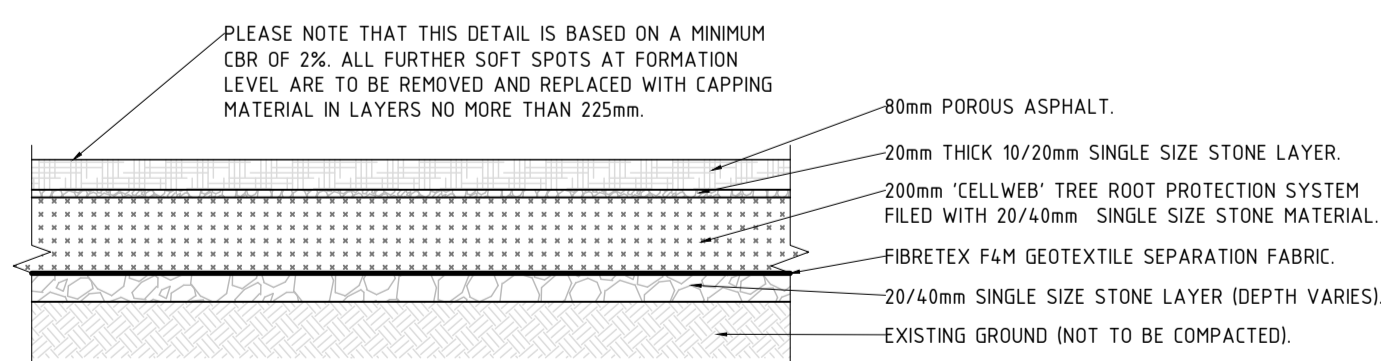

TYPICAL CROSS SECTION OF TREE ROOT PROTECTION ZONE

SCALE 1:20

TACTILE BLISTER PAVING "BUFF" IN COLOUR @ 1:12 SLOPE MAXIMUM (1:20 PREFERABLE) BLISTERED TACTILE PAVING SLABS IN ACCORDANCE WITH DETR "GUIDANCE ON THE USE OF TACTILE PAVING SURFACES" LAY 2 SLABS DEEP (800mm) AT INSET CROSSINGS

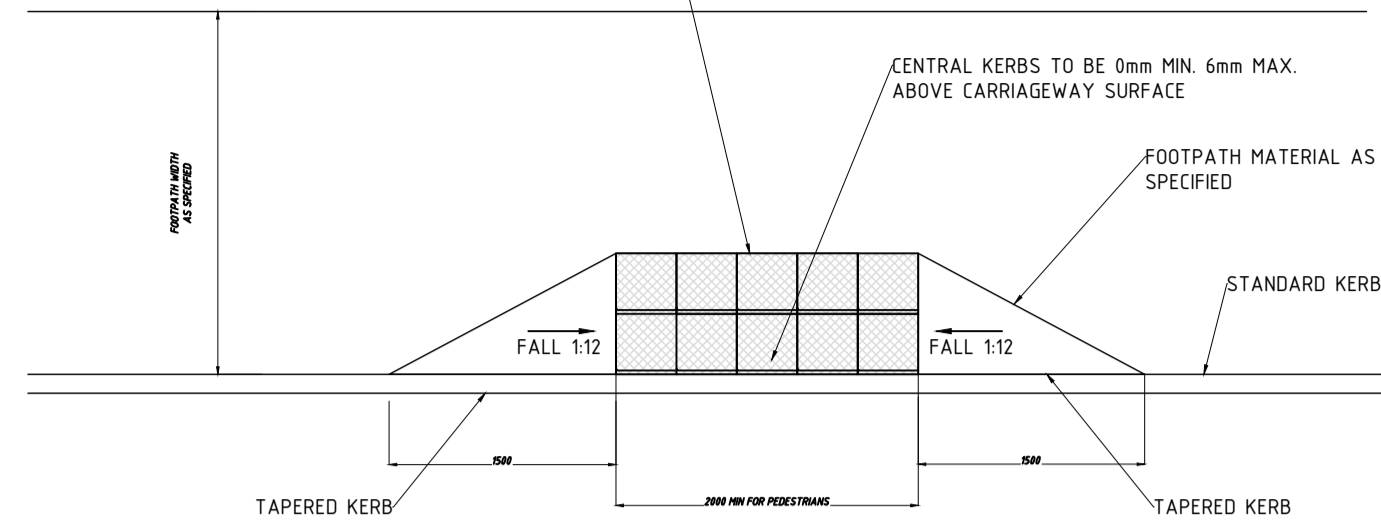

TYPICAL TACTILE PAVING & DROP KERB DETAILS (AT INSET UNCONTROLLED CROSSING)

Scale 1:50

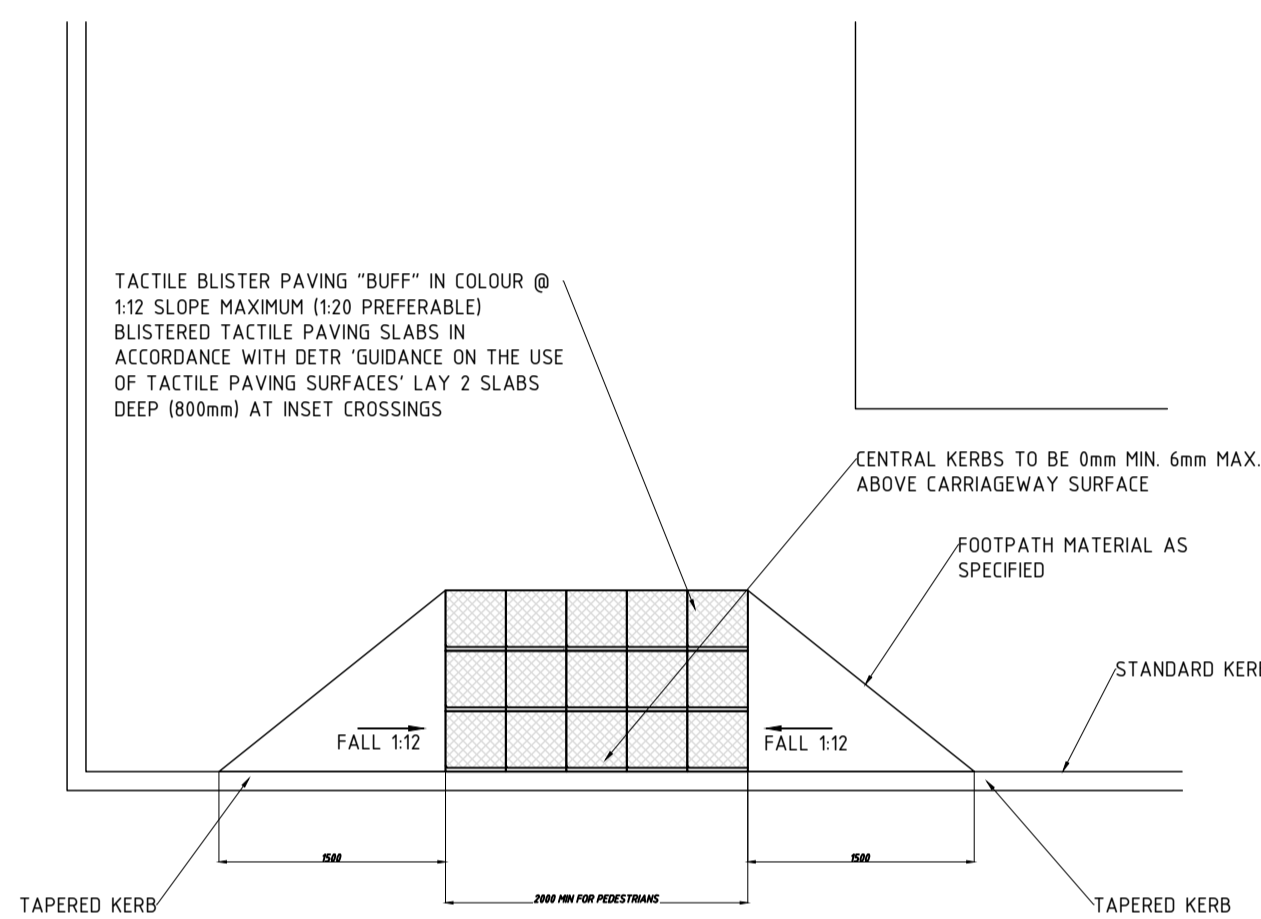

TYPICAL TACTILE PAVING & DROP KERB DETAILS (AT INLINE UNCONTROLLED CROSSING)

Scale 1:50

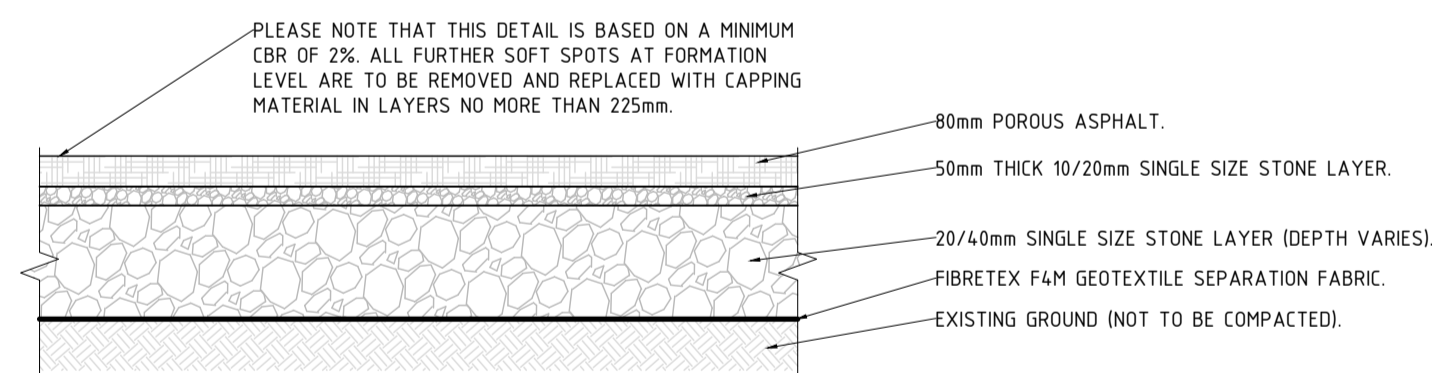

TYPICAL CROSS SECTION OF POROUS ASPHALT SURFACE

SCALE 1:20

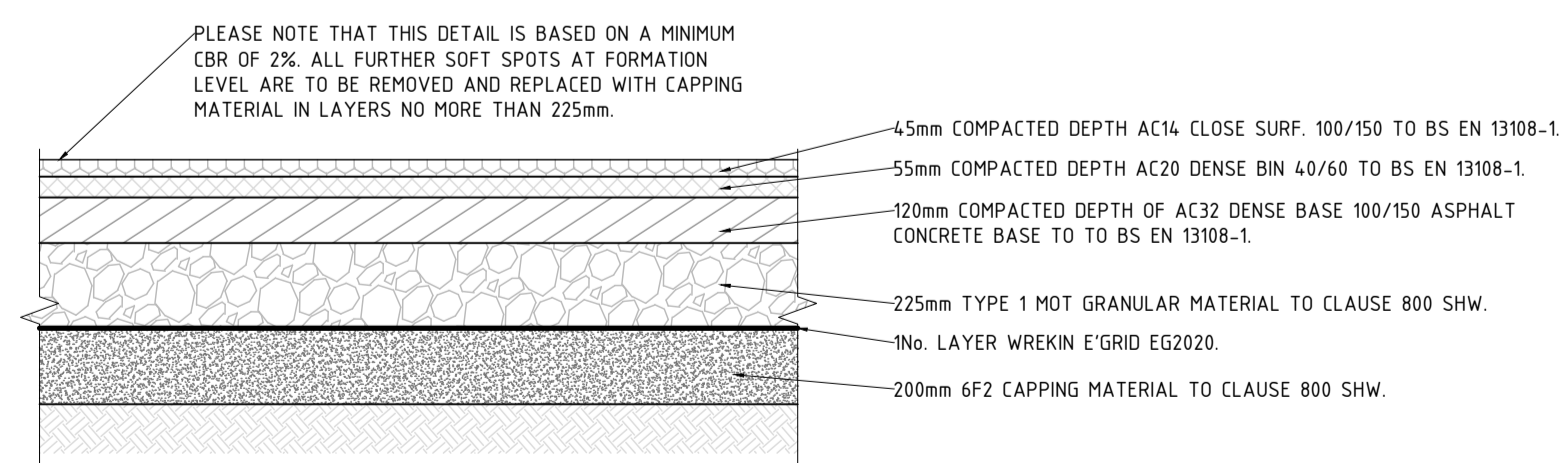

TYPICAL CROSS SECTION OF ASPHALT SURFACE

SCALE 1:20

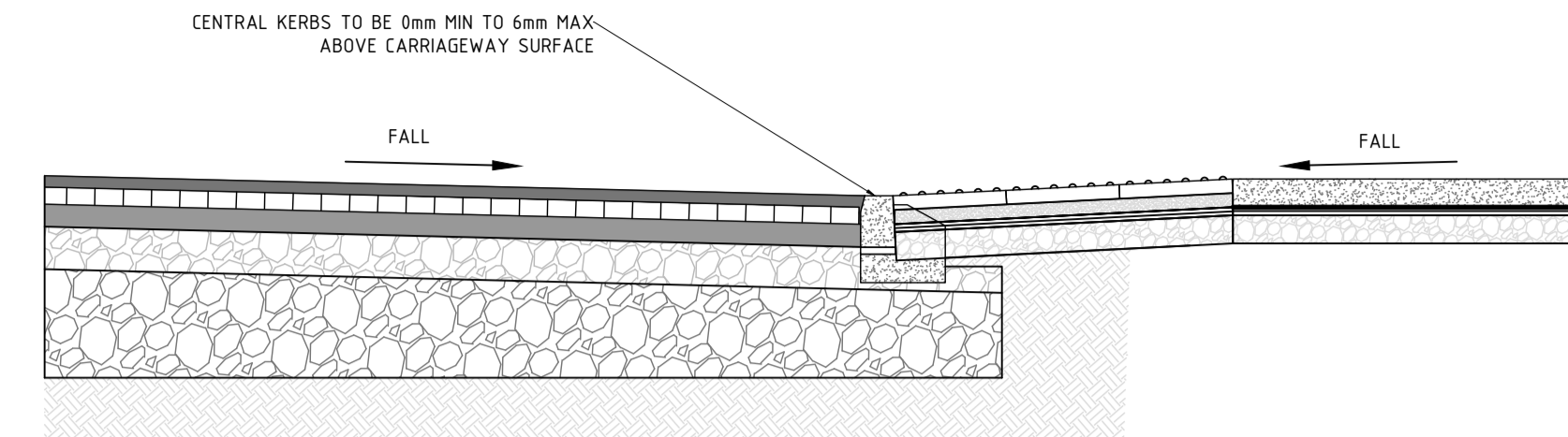

TYPICAL CROSS SECTION THROUGH FOOTPATH WITH BLISTER PAVING

Scale 1:50

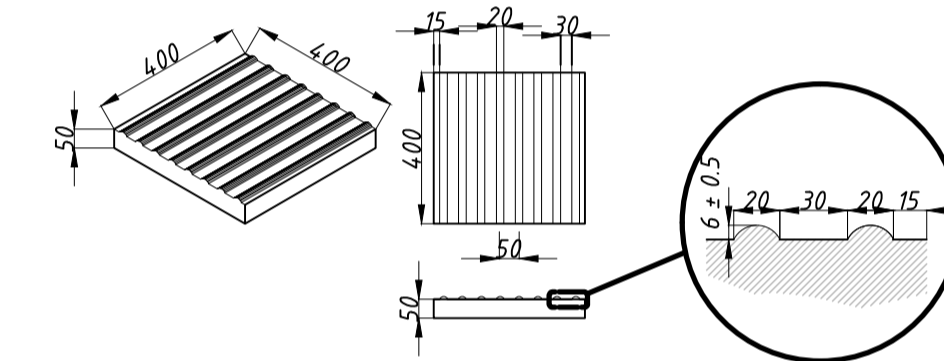
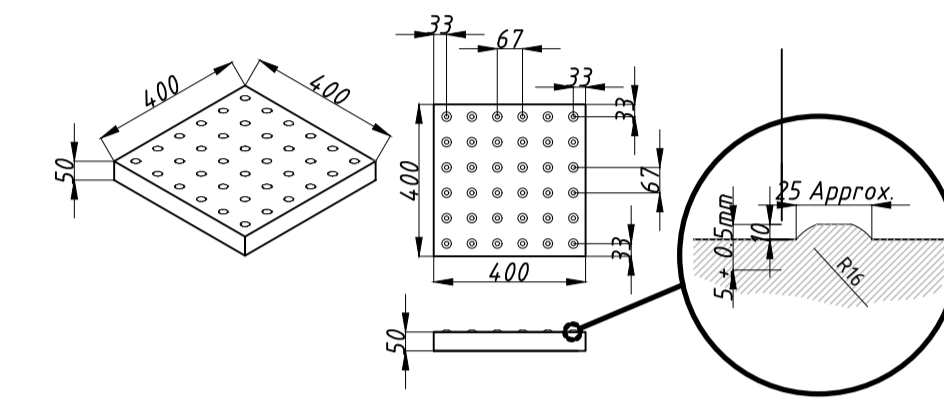

TACTILE PAVING SLAB DIMENSIONS

Scale 1:20

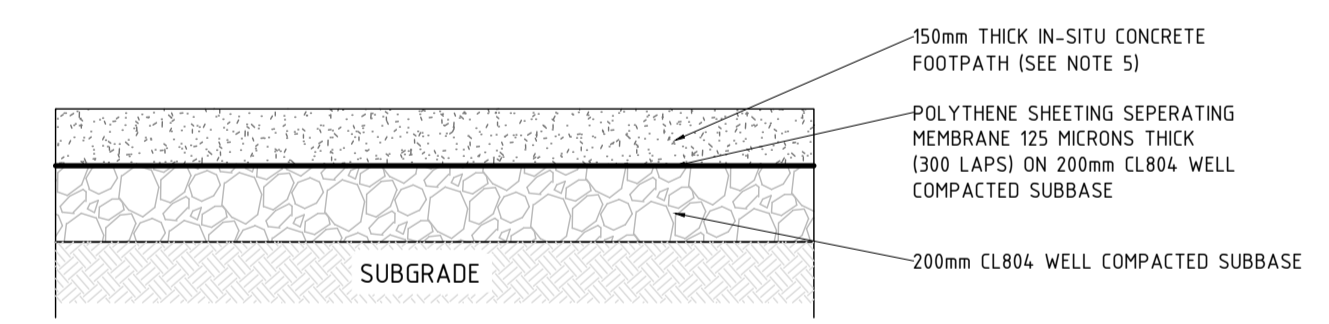

TYPICAL CROSS SECTION OF CONCRETE FOOTPATH

SCALE 1:20

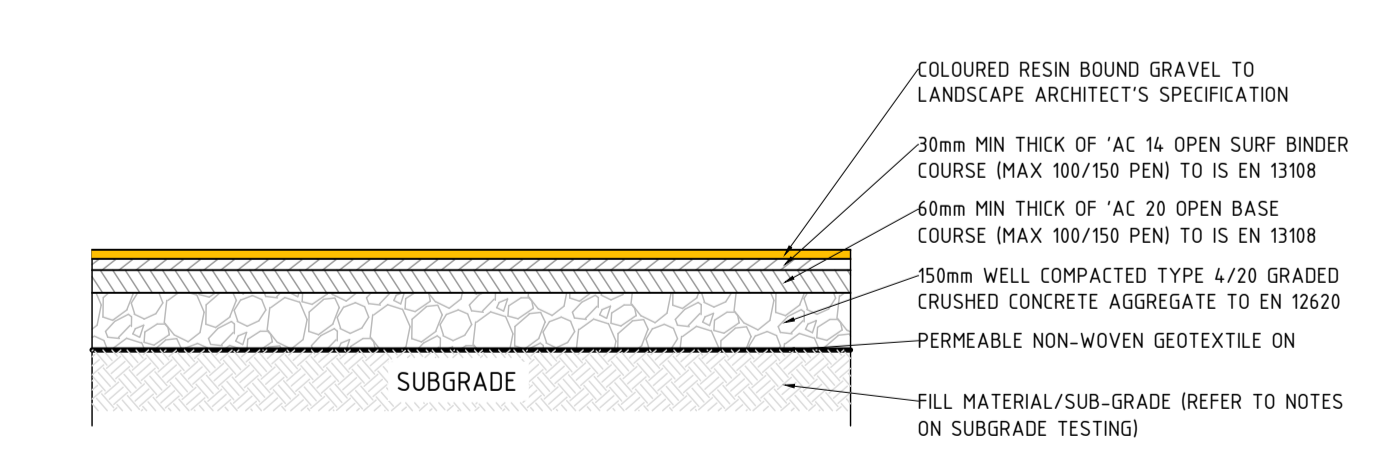

TYPICAL BUILDUP FOR RESIN BOUND GRAVEL

SCALE 1:20

- PAVEMENT:**
1. TRANSVERSE JOINTS BETWEEN NEW & EXISTING PAVEMENTS TO BE TRANSVERSE JOINTS BETWEEN NEW & EXISTING PAVEMENTS TO BE CONSTRUCTED IN ACCORDANCE WITH NRA RCD/700/3. LONGITUDINAL JOINTS BETWEEN NEW & EXISTING PAVEMENTS TO BE CONSTRUCTED IN ACCORDANCE WITH NRA RCD/700/4.
 2. THE REQUIREMENTS FOR EACH PAVEMENT TYPE TO BE IN THE REQUIREMENTS FOR EACH PAVEMENT TYPE TO BE IN ACCORDANCE WITH THE SPECIFICATION AND AS DESCRIBED HEREUNDER.
 3. ASSUMED CBR OF EXISTING GROUND -3%. CONTRACTOR TO CHECK ASSUMED CBR OF EXISTING GROUND -3%. CONTRACTOR TO CHECK GROUND CONDITIONS BEFORE COMMENCING WORKS.
 4. GROUND UNDER THE PROPOSED CELLWEB SYSTEM IS NOT TO BE GROUND UNDER THE PROPOSED CELLWEB SYSTEM IS NOT TO BE COMPACTED, TO ALLOW WATER PERCOLATION.
 5. CELLWEB SYSTEM TO BE INSTALLED TO MANUFACTURER CELLWEB SYSTEM TO BE INSTALLED TO MANUFACTURER SPECIFICATION AND METHODOLOGY. MANUFACTURER REPRESENTATIVE IS TO SUPERVISE THE INSTALLATION PROCESS.
 6. CELLWEB TO BE FILLED WITH CLEAN 20/40mm (40% VOIDS CELLWEB TO BE FILLED WITH CLEAN 20/40mm (40% VOIDS MINIMUM) SINGLE SIZED STONE MATERIAL IN ACCORDANCE WITH IS EN 13242 AND TII PUBLICATION DOCUMENT CC-SPW-00500 "SPECIFICATION FOR ROAD WORKS SERIES 500 DRAINAGE".
 7. PROVIDE FOR A PA 14 SURF PMB 65/105-70 POROUS ASPHALT IN PROVIDE FOR A PA 14 SURF PMB 65/105-70 POROUS ASPHALT IN ACCORDANCE WITH CLAUSE 6.0 OF TII PUBLICATION DOCUMENT CO-SPW-00900 "SPECIFICATION FOR ROAD WORKS - ROAD PAVEMENT BITUMINOUS MATERIAL".
 8. POROUS ASPHALT TO BE TESTED TO ENSURE REQUIRED VOID POROUS ASPHALT TO BE TESTED TO ENSURE REQUIRED VOID CONTENT IS ACHIEVED TO ALLOW SURFACE WATER PERCOLATION IN ACCORDANCE WITH CLAUSE 6.0 OF TII PUBLICATION CO-SPW-00900 "SPECIFICATION FOR ROAD WORKS - ROAD PAVEMENT BITUMINOUS MATERIAL".

THIS DRAWING IS COPYRIGHT © CroCon Engineers Ltd. All rights reserved. Dimensions are in millimeters unless otherwise stated. Figures and dimensions are for information only. All works to be in accordance with Current Building Regulations and Codes of Practice unless otherwise stated. This drawing is for the use of the client only. It is not to be used for any other purpose without the written consent of CroCon Engineers Ltd. The client is responsible for ensuring compliance with Building Regulations and Codes of Practice. The client is responsible for ensuring compliance with Building Regulations and Codes of Practice. The client is responsible for ensuring compliance with Building Regulations and Codes of Practice.

Drawn By	Checked By	Approved By	Issue No.	Scale	Project	Revision	Stage
AH	CC	CC	0	NTS @A1	22240 - CRO - X - XXX - DR - CE - 03812	0	Planning

CroCon Engineers Ltd.
Consulting Engineers
Unit 1, Building 6500, Avenue 6000,
Cork Airport Business Park, Cork
E: info@crocon.ie Tel: 021 431 0709

Client: MJOS
Project: "Abbey Wood, Baneshane, Midleton, Co. Cork.
Date: Sections & Details for Proposed Pavement Works